

Hello,

Thanks for buying the Rade GARAGE 701 fairing kit. Before you start enjoying the conversion of your 701 into an Adventure bike, you can increase your self-confidence as a great mechanic by reading through the following installation instructions. We suggest you find 3-4 hours to complete installation. The kit is designed so that one pair of (clever) hands are enough

0/ What you get in the package:

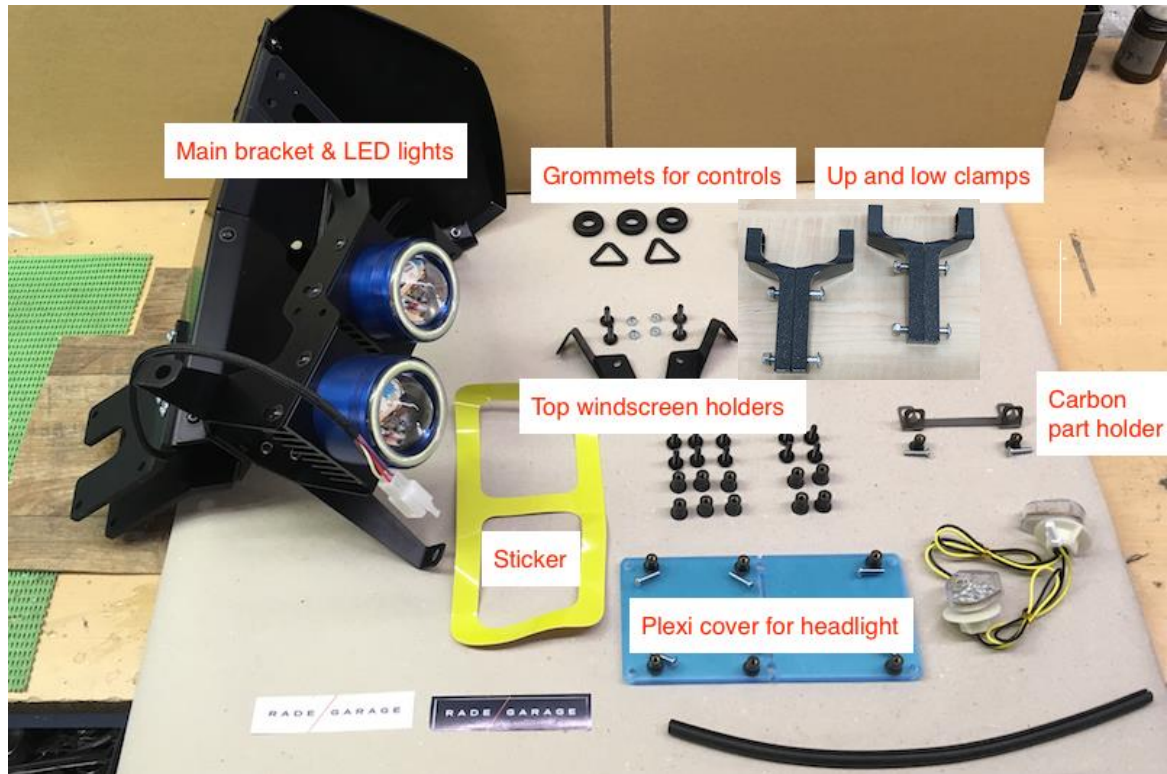

The picture on the left is what your bike should look like right before you put on the windshield and side panels. The picture on the right is what your bike should look like with everything installed.



NOTE: It is highly recommended you install everything finger tight first to ensure proper fitment and alignment, then go back and tighten everything up. On bolts that DO NOT have a nylon-insert lock nut, I recommend using blue loctite on the bolt threads.

1/ Remove the OEM headlight and unplug/unbundle all cables from the black plastic part so that it is empty (see pix.). You totally remove this part from the bike.



2/ Dont get scared ☺ You have to unbundle everthing and you will see this...



3a/ Now you have to disconnect the cables from electronic/fly-by-wire throttle.

You will find the connectors under the seat in front of air box. It is easier when you remove the side pannels first. You will have to do it anyway... And you can access the connectors from the left side as on the pix.



3b/ Next you have to completely remove away the black plastic part. To be able to do so, you have to cut it in left down corner by sharp knife or blade and take out the cables.

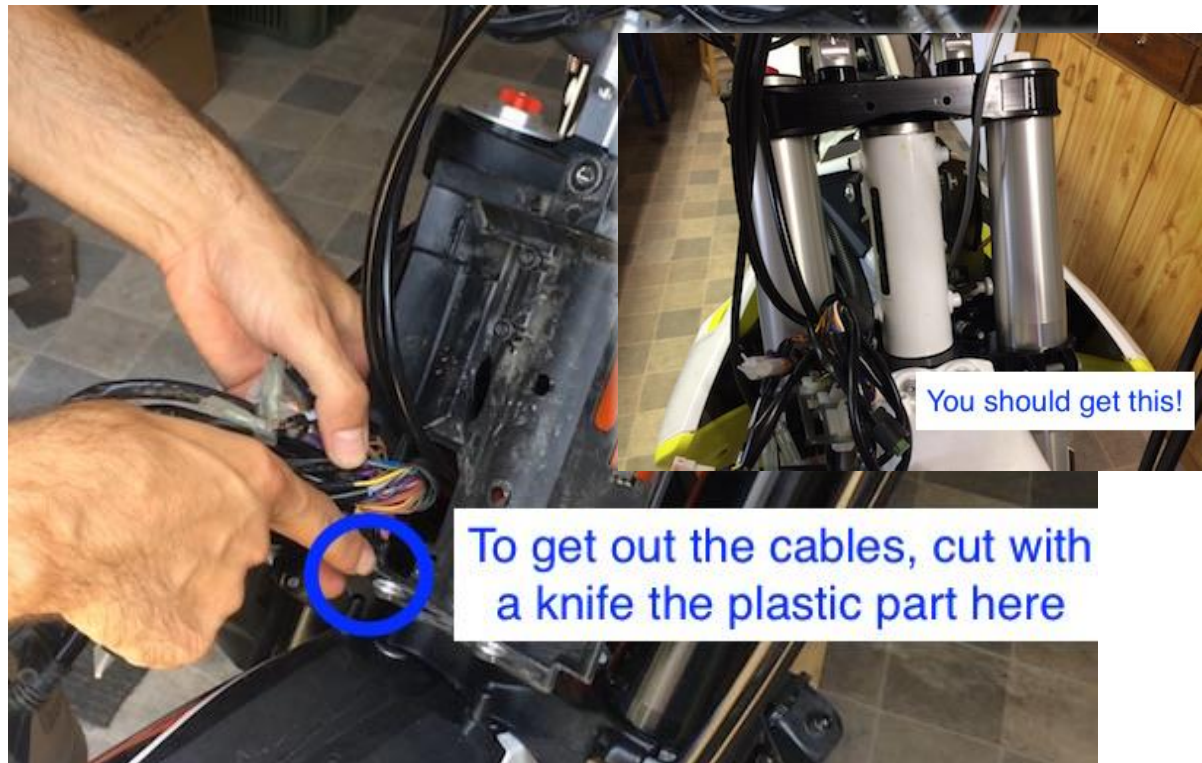

4/ Remove the controls and tacho

4a/ remove the tacho including the rubber grommets – you will need them later



4b/ disconnect the control lights as on the pix and push the controls upwards to get them out and keep them for later!



4c/ take very small screw driver or knife and press the three secure pins and push the ABS button upwards to get it out



5/ Take the main bracket and you will insert all controls and OEM tachometer

5a/ Insert the big rubber grommets into the three holes in the top plate and then push inside them from top side the controls...

5b/ Use the OEM grommets for tacho and insert them too into the top plate and then secure the OEM tacho with OEM bolts from bottom side - **Tighten very carefully because these bolts go into plastic!**



5c/ Insert the ABS button and secure it from bottom side with supplied rubber triangle grommet as on the pix.



6a/ Install the clamps to the OEM holes (blind with plastic inserts – remove the inserts with pliers) and use M6x12 bolts to fasten the clamps. Up and low clamps are the same.



NOTE: strictly follow the order of 6b, 6c and 6d

6b/ Insert the main bracket and secure with the ONLY M6x40 bolt and nut as on the picture below.

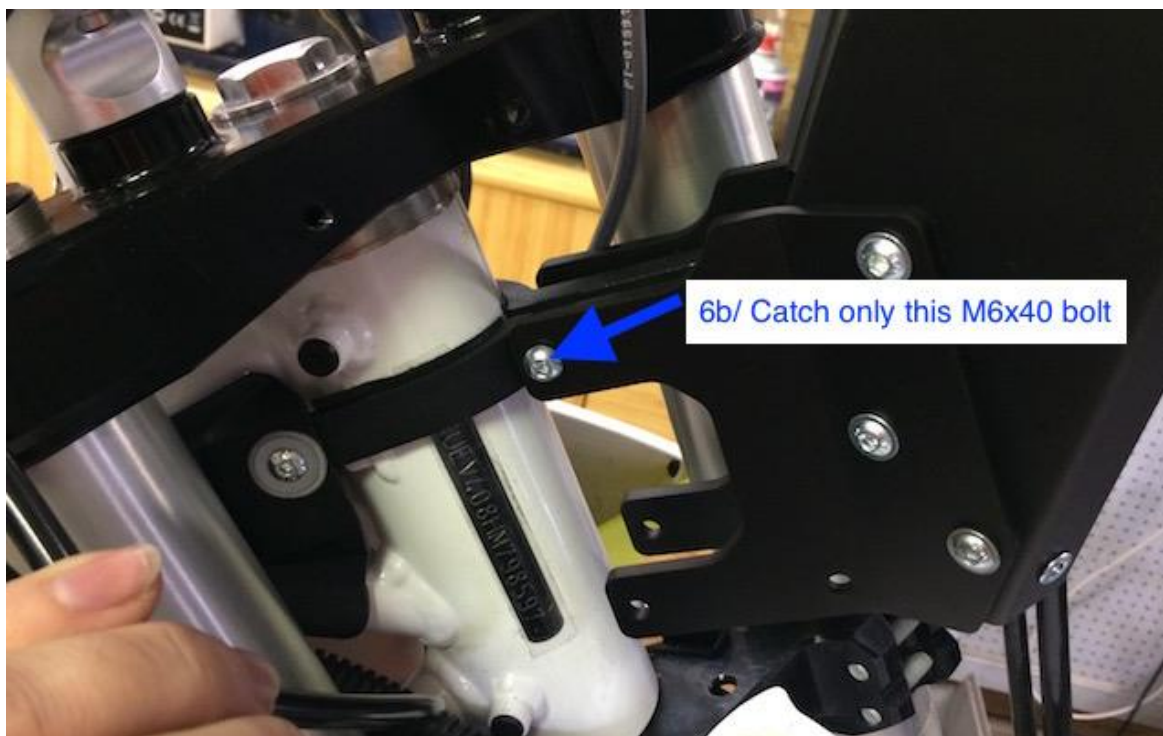

6c/ for easier access you can bent the main bracket a bit towards the handle bars and insert the main electric cable from the bottom into the main bracket

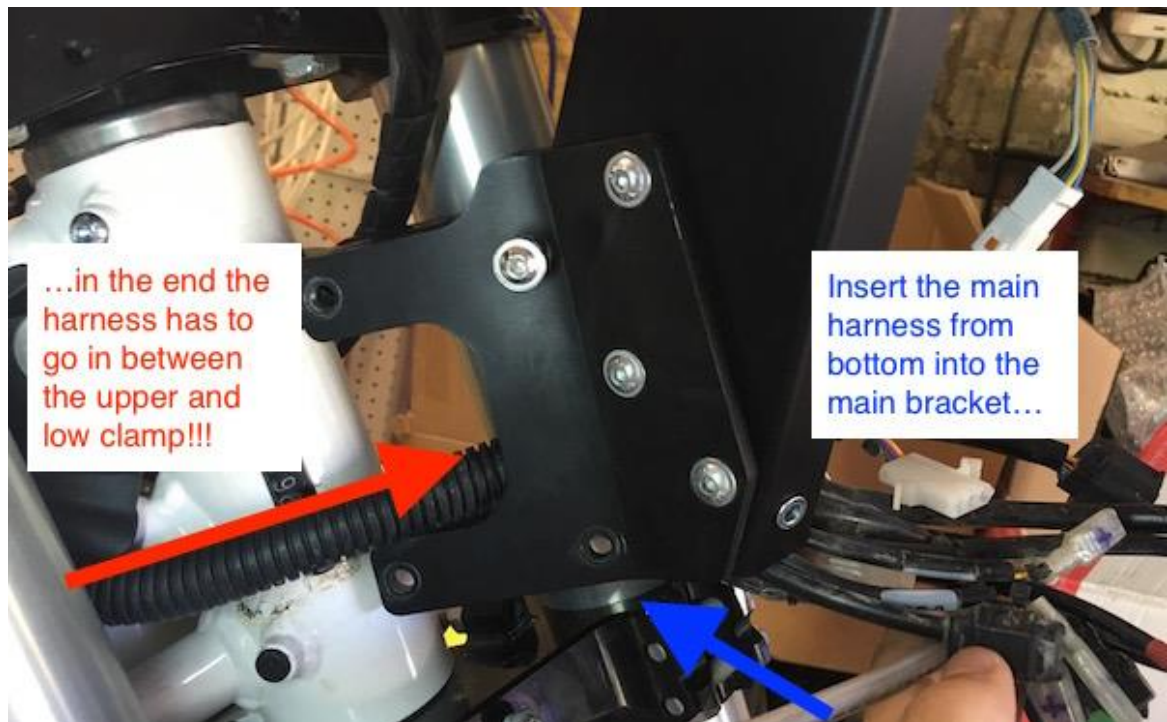

6d/ insert the low clamps and all 3 remaining M6x40 bolts secure them with nuts. **Thighten them but not strong yet!**



7/ Connect all electrical connectors together again and make sure the sockets for Lights and Turn signals are visible

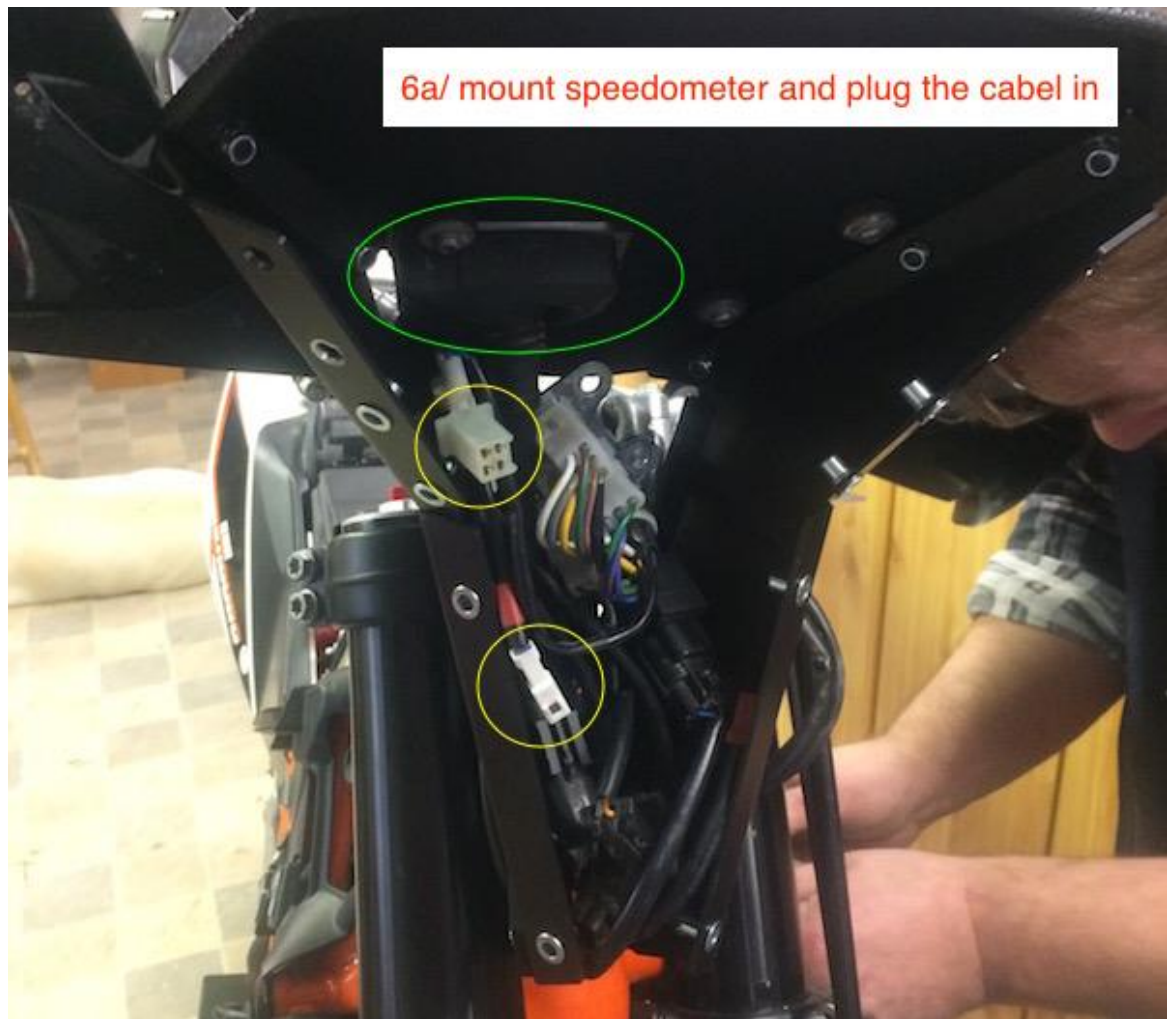

Note! There still must be space for the LED Balast box

Before you proceed!

1/ Make sure all the electrical wiring are well connected. My TIP: switch on the key and check speedo function... put on and off the ABS unit

2/ Take the F2 LED headlight assembly, and holding it in one hand, plug it into the wiring harness to ensure it is functioning properly (low beam, high beam).

3/ Disconnect the F2 LED headlight assembly and turn the handlebars left and right to make sure all cables are long enough and not pulled to tight.

4/ Fully tighten the M6x40 bolts on both the top and bottom steering neck clamps and make sure the clamps are solidly in place.

8/ Next you install the F2 LED headlight assembly:

- a/ Plug the 701LED headlight into the OEM headlight electrical connection
- b/ Make sure you can later reach the connectors for turn signals
- c/ Fasten the LED lights holder to the main bracket
- d/ Mount the covering plate

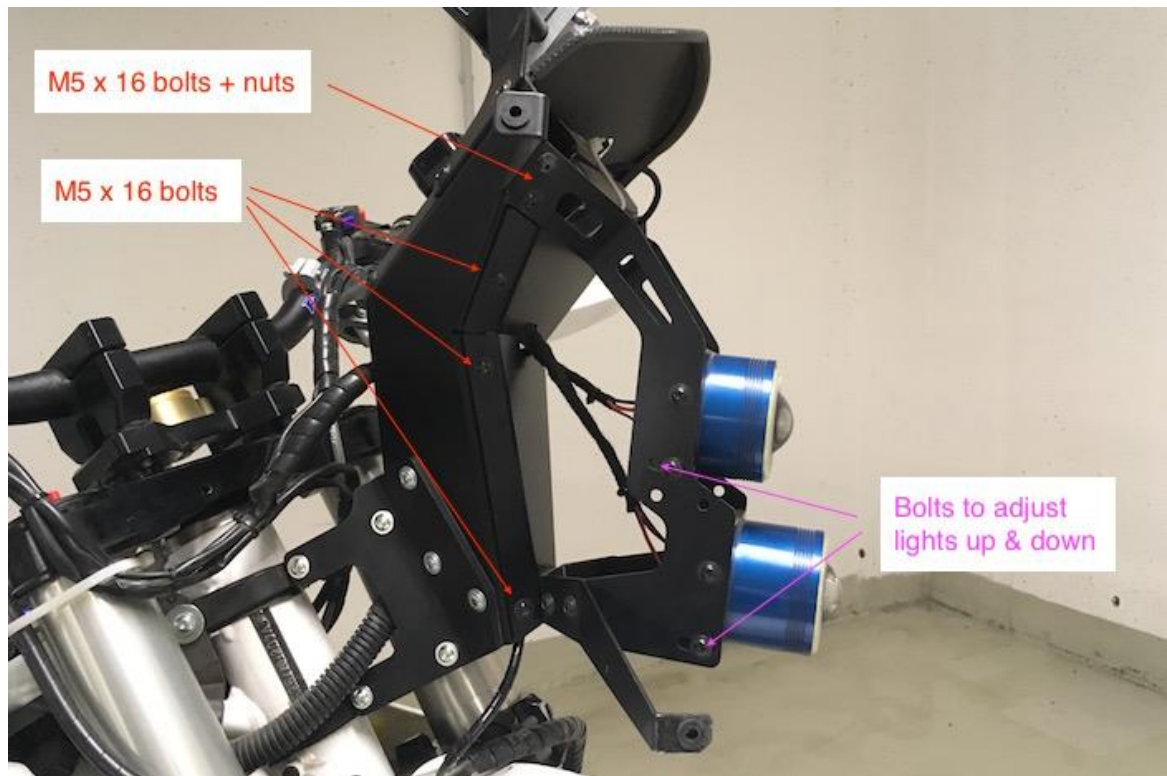

8d/ The light with shorter tube goes up and the second with longer tube (low beam) goes down.

9/ You have take out the white rubber grommet from OEM side panels and insert them into the fairing side panels as on the picture.



10/ Mount the fairing together first

10a/ It is optional if you like it or not, stick the yellow frame sticker on the windscreen and mount the plexi cover with six M4x12 bolts and rubber nuts – **don't overtight** otherwise the plexi cover might crack! Dont forget to mount also the metal holder as on the pix.



10b/ Mount first together the fairing side panels and windscreen **only on four** M5x16 bolts and ruber nuts.





11a/ Insert the rubber nuts into the four fairing holders as on the pix.

11b/ Put on the fairing – to make it easier turn the handle bars to one side. Than tight the fairing with M5x16 bolts through the screen and with M5x20 bolts through the bottom holders

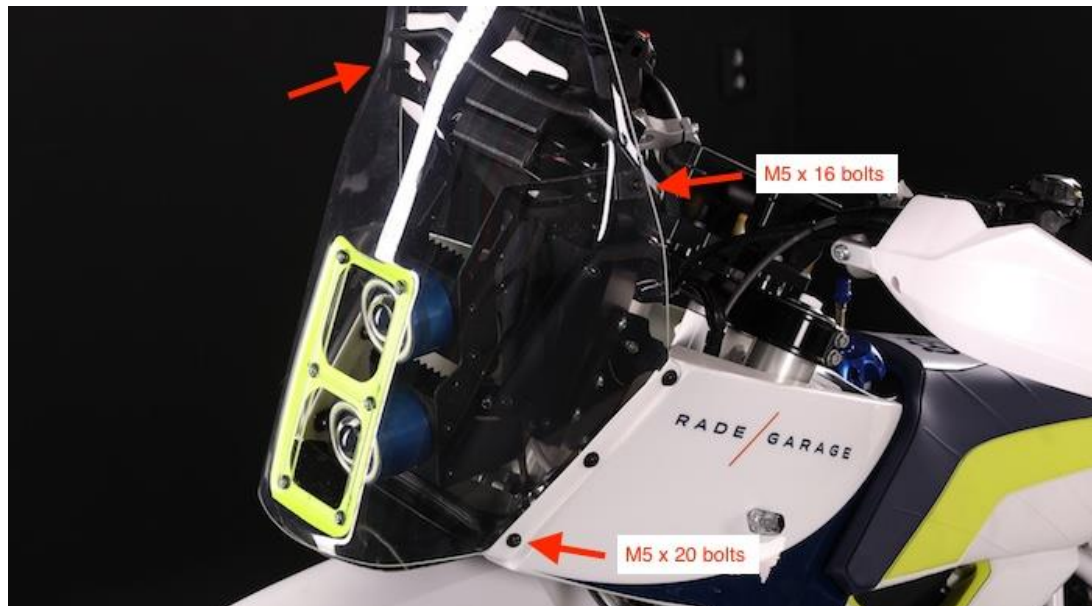

Congratullations – you are a good mecanic! Enjoy your upgraded Adventure bike! ☺
If you have any questions, feel free to send me an email at rade@radegarage.com

Thanks!
R/G Team